

# ***EZELOAD***

*Automatic Wagon Loader for Bagged Commodities*

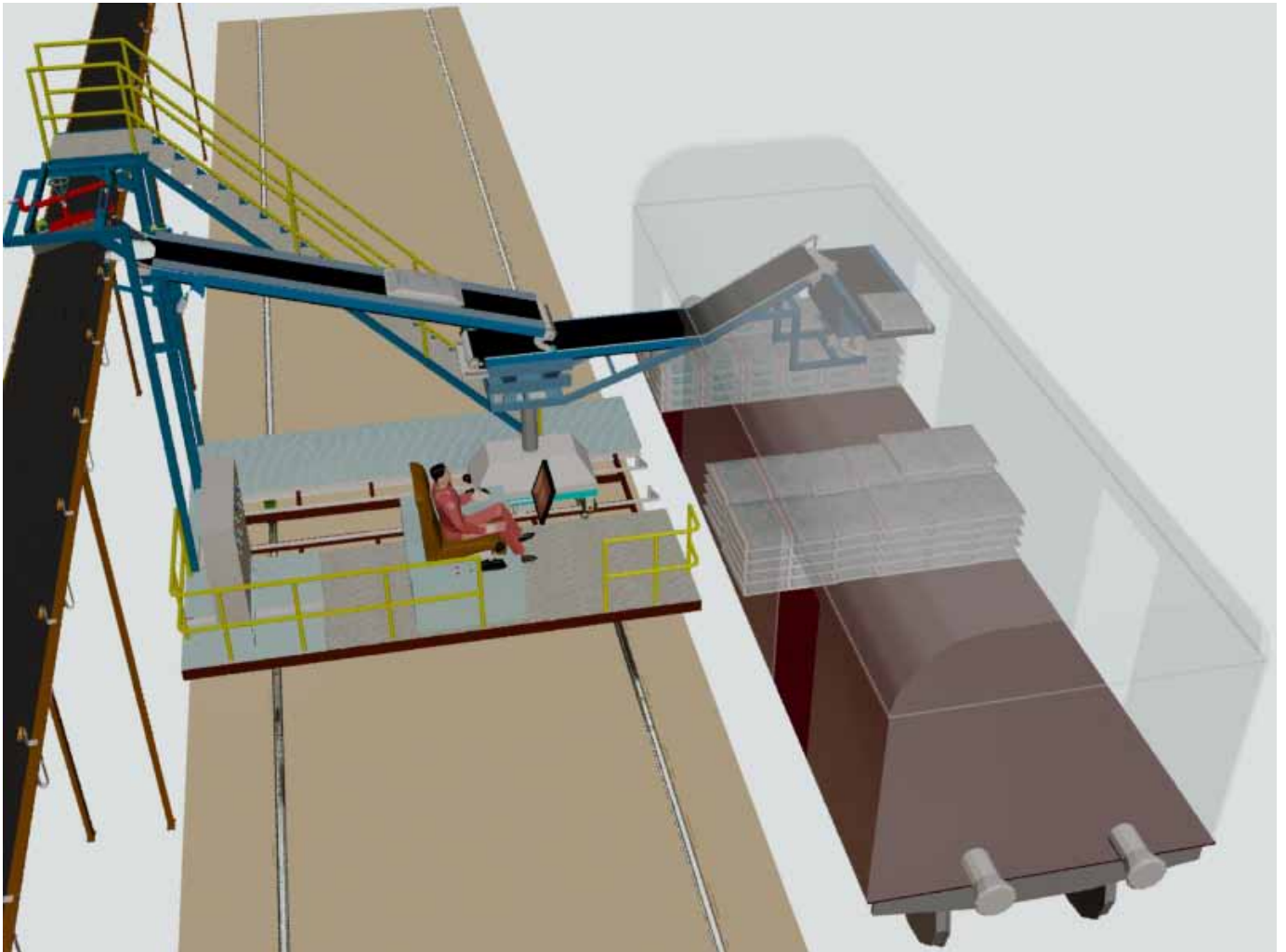

Patent pending

Whatever the load, **EZELOAD** can handle it *Efficiently & Profitably!!*

## Introduction

The EZELOAD<sup>®</sup> wagon loader has been exclusively designed by Zebec to meet a variety of material handling requirements.

The fully automated wagon loader is customized for Indian wagons of types such as BCNHL & BCNA (Bogie covered wagon) and BOXN (Bogie open top wagon). Incorporated with a telescopic belt, it caters to complex stacking needs and results in a drastic reduction in material handling time, due to increased productivity.

**Unique feature includes two designs namely:**

- 1) Standard Design (As Shown),
- 2) Customized Design (tailor made according to the operational layout of the clients system)

### Technical Specifications

#### Components

- Telescopic / articulated Conveyer
- Bag Diverter
- Belt Conveyer 1
- Belt Conveyer 2

#### Handling Rate

- 1,200 bags per hour.

#### Power Requirement

- Installed power - 20 kW
- Operating power- 14 kW

#### Space Requirement

- 5.8 m x 4.6 m

#### Movement

- Three directional movement along the X, Y, Z axis
- Telescopic conveyer luffing of (+/-) 15° with 180° slew.
- Hydraulic Lifting Arrangement (HLA)

### Competitive Advantage

#### Fully Automated Wagon Loader

- No labour required for loading thus a drastic reduction in operational expenditure.
- Saves time and increases productivity.
- Suitable for confined space working conditions.
- Low power consumption thus benefits during long production hours.

#### Customized for Indian Wagons

Can be used for following wagon types:

- BCNHL,
- BCNA,
- BOXN

#### Additional Features

- Ergonomically designed structure
- Display System monitors the operations inside the wagon.
- Suitable for hooking upto an existing plant conveyor
- Corrosion Resistant
- Equipped with Geared Motor

## Suitable For Various Bagged Cargoes



**Cement**



**Fertilizer**



**MOP**



**Urea**



**DAP**



**Food Grains**

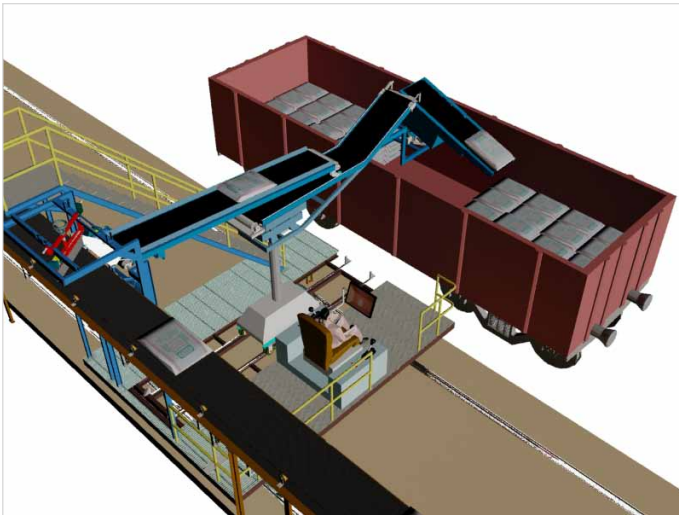

Loading process into BOXN type open wagon

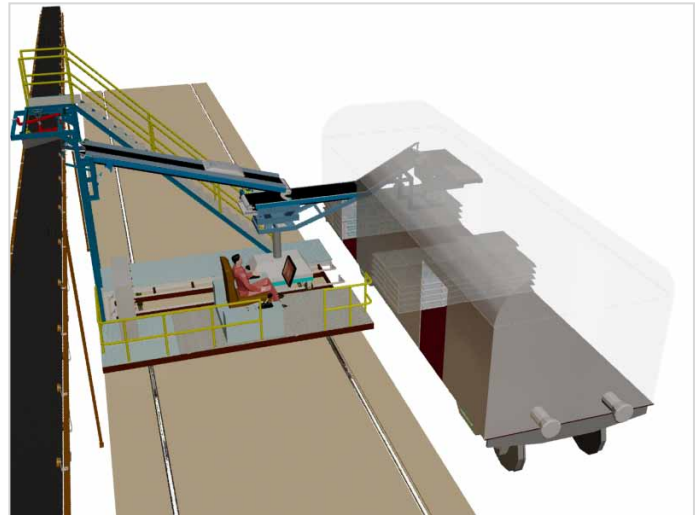

Loading process into BCNA & BCNHL type closed wagon

## Loading Process

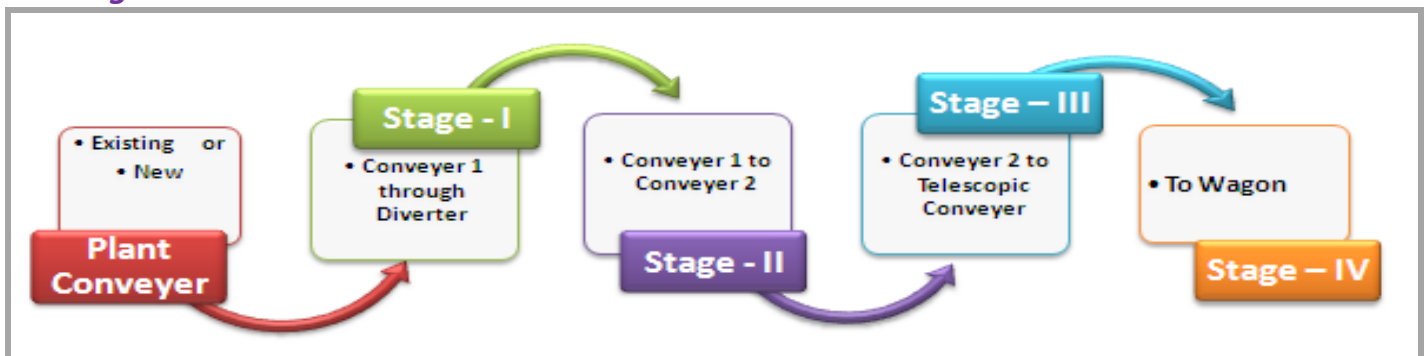

- Wagon loading process comprises of 4 dedicated stages, starting from Plant conveyor to the Wagons
- **Stage – I** : Diverter directs bags from Plant conveyor to Conveyor 1.
- **Stage – II** : Bags fall from conveyor1 to conveyor 2.
- **Stage – III**: Conveyor2 leads the bag to Telescopic/articulated conveyor.
- **Stage – IV**: Telescopic conveyor places the bag in the wagon.
- The HLA will enable that the stacking is properly done. This will ensure that even open wagons can be filled easily.

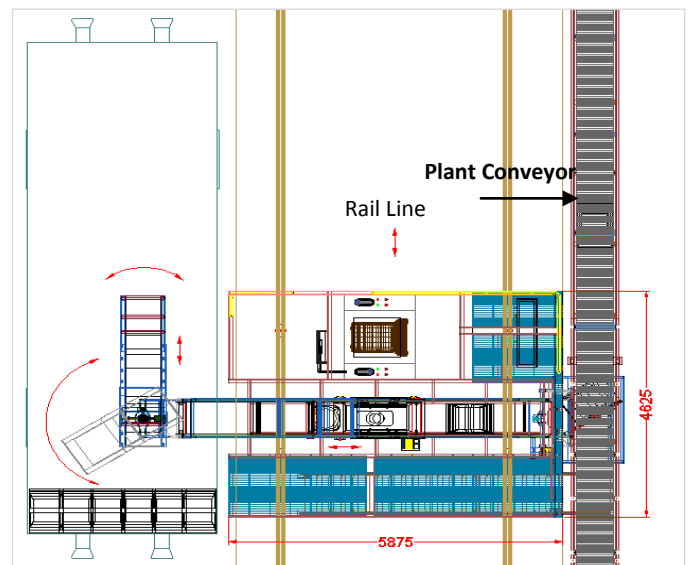

GA of Working Loader

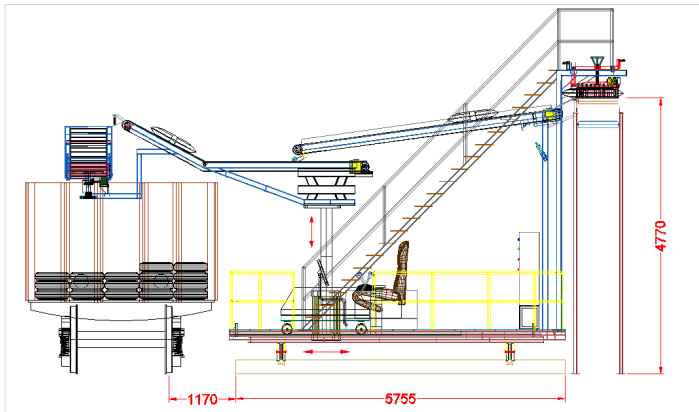

**Working on BOXN type open top wagon**

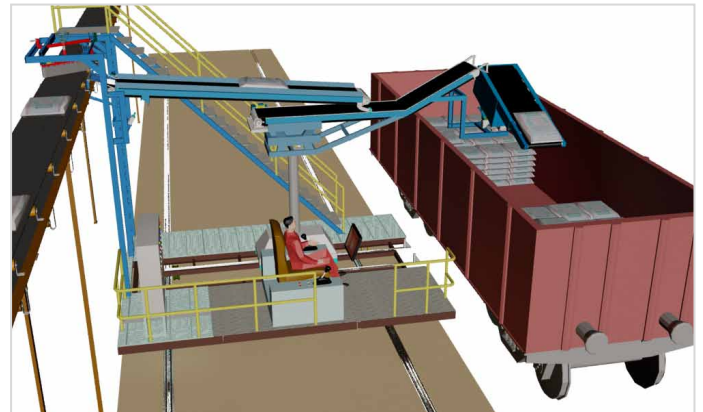

**Working on BOXN type open top wagon**

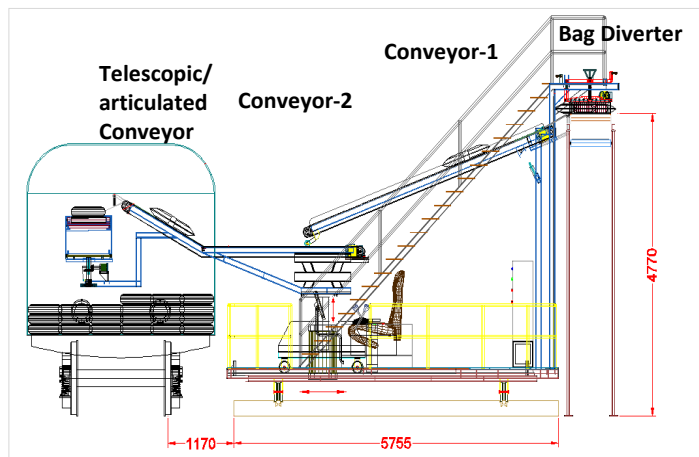

**Working on BCNA & BCNHL type closed wagon**

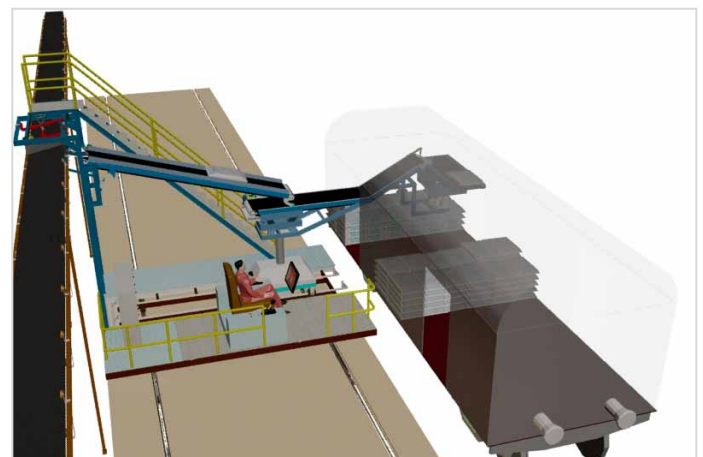

**Working on BCNA & BCNHL type closed wagon**

## Contact Us:-

### Zebec Marine Consultants & Services Pvt. Ltd.

#### Corporate Office

61B, 6<sup>th</sup> Floor, Mittal Court,  
Nariman Point,  
Mumbai 400021, India  
Phone: +91 22 30205000  
Fax: +91 22 30205007  
E-mail: zebec@zebecmarine.com

#### Marine Projects

411-414, Raikar Chambers,  
Govandi (East),  
Mumbai 400088, India  
Phone: +91 22 30570743  
Fax: +91-22 30570748  
E-mail: zebec@zebecmarine.com

Discretion Note - This design/specification is the property of Zebec Marine Consultants & Services, and must not be copied or replicated without the explicit permission of Zebec's Marine Consultants & Services.